

RECOMMENDED P.C.B. LAYOUT

NOT TO SCALE

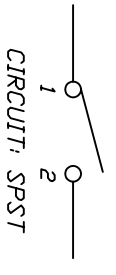
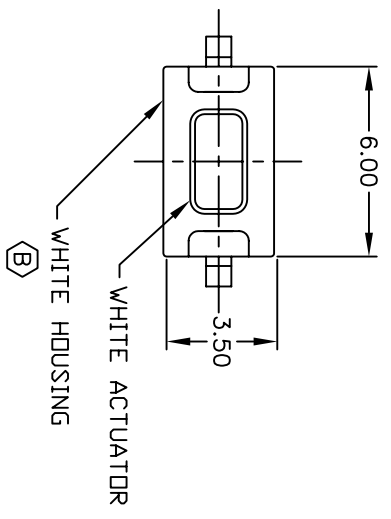

NOTES:

1. ALL DIMENSIONS IN MM
2. GENERAL TOLERANCE: X.X=±0.4
X.XX=±0.25
3. TERM. NOS. FOR REFERENCE ONLY.
4. RATINGS: 12VDC, 50mA
5. CONTACT MATERIAL: SILVER
6. OPERATING FORCE: 260±50gf
7. TRAVEL: 0.25±0.1mm
8. CONTACT RESISTANCE: 100mΩ-Ohms Max.
9. MECHANICAL/ELECTRICAL LIFE: 30,000 CYCLES
10. PACKAGE: BULK
11. 2002/95/EC (ROHS) COMPLIANT

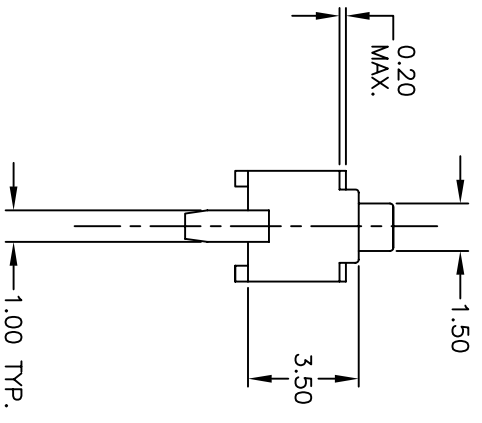
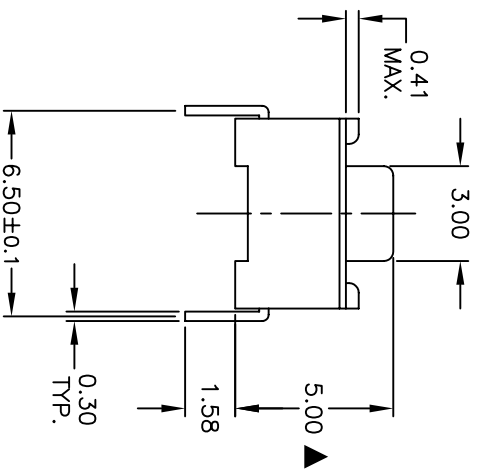

REV.	ECN NO.	DESCRIPTION	DATE	CHKD
C	16632	UPDATED NOTES	11/9/06	TN
B	14841	CORRECTED HOUSING COLOR	4/7/05	AR
A	12384	RELEASED FOR PRODUCTION	11/21/02	CJB

TITLE		SCALE	DATE	DR	DWG	REV
E-SWITCH®		4:1	11/9/2006	TN	D310384	C
TL1107BF260BQ						

THE INFORMATION CONTAINED IN THIS DOCUMENT IS PROPRIETARY TO E-SWITCH AND IS NOT TO BE COPIED OR TRANSFERRED