

RECOMMENDED P.C.B. LAYOUT

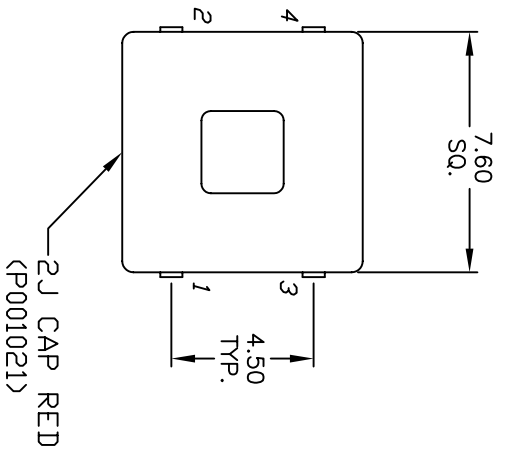

2J CAP RED (P001021)

L.E.D. INFO:

PARAMETERS	SYMBOL	Forward Voltage	UNITS
POWER DISTRIBUTION	P_D	100	mV
Ave FORWARD CURRENT	I_F	30	mA
PEAK FORWARD CURRENT	I_{PF}	120	mA
REVERSE VOLTAGE	V_R	5	V
FORWARD VOLTAGE	F_V	2.5	V
PEAK EMISSION WAVELENGTH	λ_D	660	nm
REVERSE CURRENT	I_R	100	μA
LUMINOUS CURRENT	I_V	22	mcd

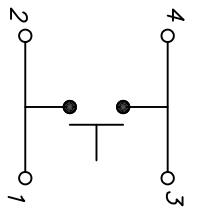

CIRCUIT: SPST

CONTACT CONFIGURATION

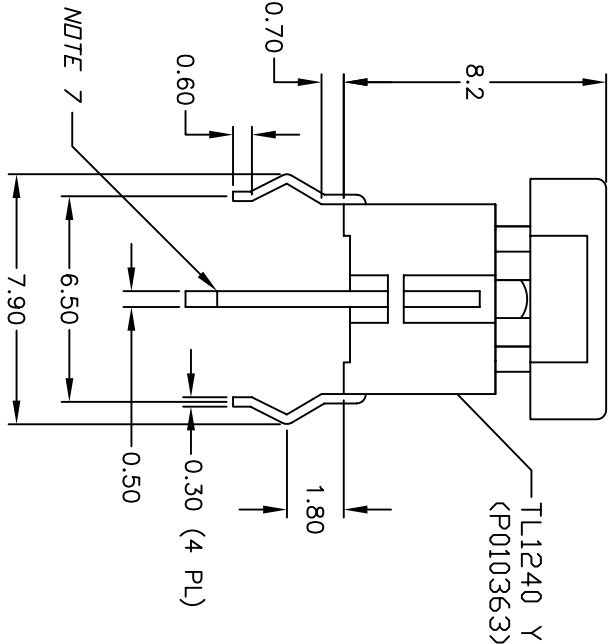

NOTE 7

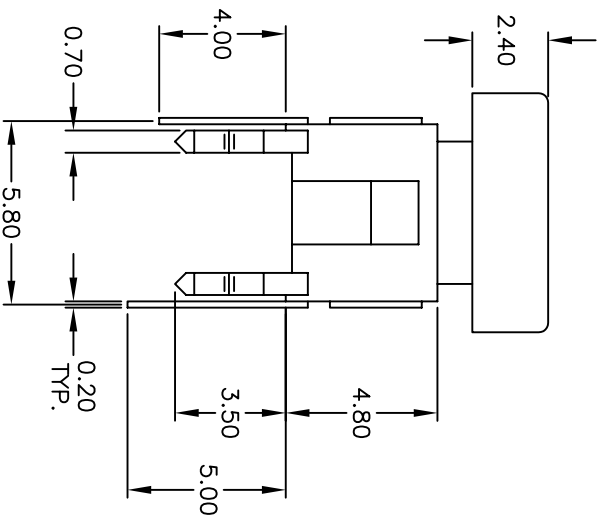

0.20 TYP.

- NOTES:
1. ALL DIMENSIONS IN MM
 2. GENERAL TOLERANCE: X.X=±0.4
X.XX=±0.25
 3. RATING: 50mA, 12VDC
 4. TRAVEL: 0.25 +0.2/0.1mm
 5. OPERATING FORCE: 160±50gf
 6. CONTACT RESISTANCE: 100mΩ-0hms Max
 7. SHORTER LEAD, WITH COLOR IS NEGATIVE (CATHODE)
 8. 2002/95/EC (ROHS) COMPLIANT

E-SWITCH®

REV.	ECN NO.	DESCRIPTION	DATE	CHKD	PH
B	15297	CHANGED TITLE, ADD ROHS NOTE	9/19/05		PH
A	11324	RELEASED FOR PRODUCTION	3/23/01	CJB	CJB

TITLE	SCALE	DATE	DR	DWG	REV
TL1240YQ2 JRED	4:1	3/23/01	CJB	XP0194P	B

THE INFORMATION CONTAINED IN THIS DOCUMENT IS PROPRIETARY TO E-SWITCH AND IS NOT TO BE COPIED OR TRANSFERRED