

ISOMETRIC

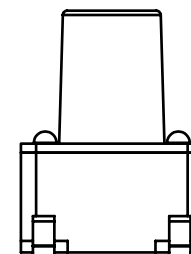
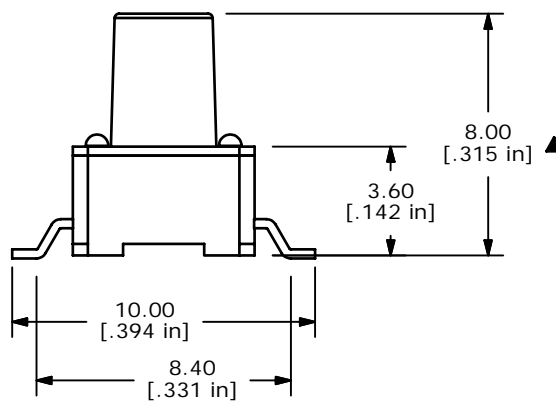
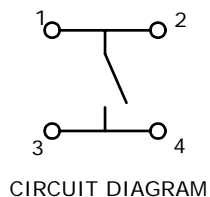

- NOTES:
1. ALL DIMENSIONS IN MM
 2. GENERAL TOLERANCE: X.X=±0.4
X.XX=±0.25
 3. TERM. NOS. FOR REFERENCE ONLY.
 4. RATING: 50VDC, 50mA
 - ▲5. OPERATING FORCE: 260 ± 50gf
 6. TRAVEL: 0.25mm ± 0.1mm
 7. CONTACT RESISTANCE: 100 MILLI OHMS MAX. (INITIAL)
 8. MECHANICAL/ELECTRICAL LIFE 100,000 CYCLES MIN.
 - ▲9. SILVER CONTACTS
 - ▲10. PACKAGING: TAPE AND REEL, 400 PCS PER REEL
 11. ▲DENOTES CRITICAL PARAMETER
 12. 2002/95/EC (ROHS) COMPLIANT

D	16571	UPDATE NOTES	10/24/2006	AR
C	15992	UPDATE NOTES	4/27/06	AR
B	14466	CORRECT NOTE 9	11/8/04	AR
A	13509	RELEASED FOR PRODUCTION	10/6/03	AR
REV	PCR NO	DESCRIPTION	DATE	BY

E-SWITCH®

TITLE TL3301CF260QG

SCALE	DATE	DR	DWG	REV
4:1	10/6/2003	AR	D310539	D

THE INFORMATION CONTAINED IN THIS DOCUMENT IS PROPRIETARY TO E-SWITCH AND IS NOT TO BE COPIED OR TRANSFERRED