

CIRCUIT: SPDT
CONTACT CONFIGURATION

| SWITCH FUNCTION | | |
|-----------------|--------|--------|
| PDS. 1 | PDS. 2 | PDS. 3 |
| DN | NONE | DN |
| 2-3 | OPEN | 2-1 |

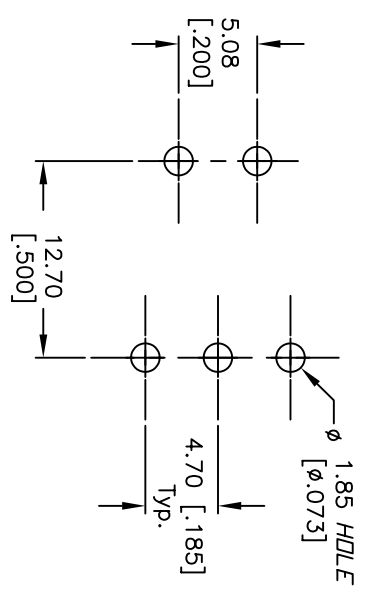
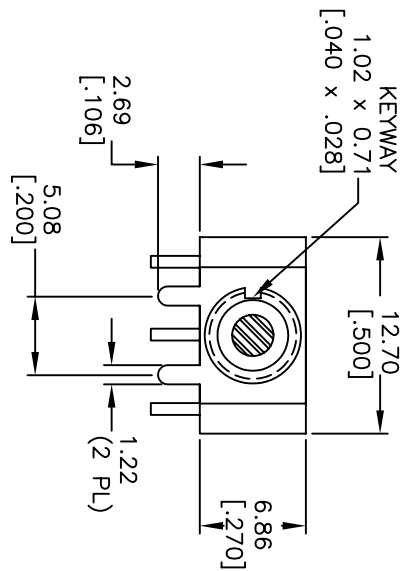

RECOMMENDED P.C.B. LAYOUT

- NOTES:
1. ALL DIMENSIONS IN MM [INCH]
 2. GENERAL TOLERANCE: X.X=±0.4 X.XX=±0.25
 3. TERM. NOS. FOR REF. ONLY
 4. RATING: 5A @120VAC or 28VDC 2A @250VAC
 5. FIXED TERM. & MOVING CONTACT: Copper Alloy W/SILVER plate
 6. ELECTRICAL LIFE: 50,000 make-and-break cycles ON OPPOSITE SIDE at full load.
 7. INSULATION RESISTANCE: 1,000M ohm min.
 8. DIELECTRIC STRENGTH: 1,000V RMS @sea level.
 9. OPERATING TEMP.: -30°C to +85°C.
 10. 2002/95/EC (ROHS) COMPLIANT

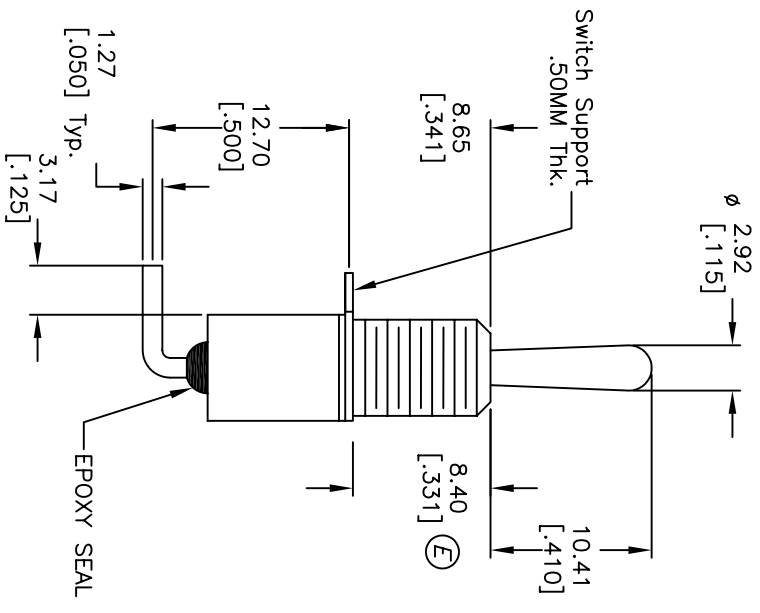
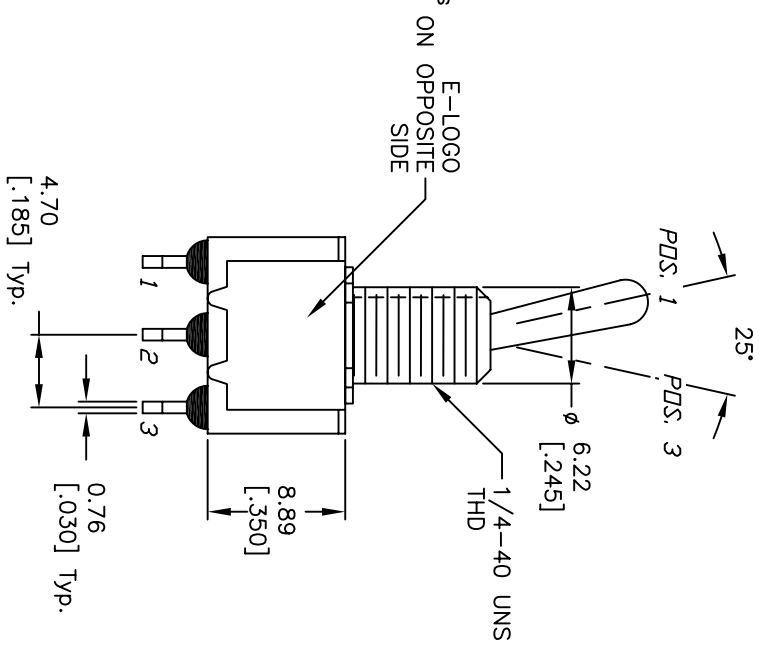

| | | | | |
|------|---------|-----------------------|----------|------|
| F | 15899 | DIM FROM 9.14 TO 8.65 | 3/27/06 | PH |
| E | 15537 | DIM FROM 8.89 TO 8.40 | 11/16/05 | PH |
| D | 15503 | ADD ROHS NOTE | 11/7/05 | PH |
| C | 12046 | REVISED AND REDRAWN | 4/9/02 | CJB |
| REV. | ECN No. | DESCRIPTION | DATE | CHKD |

| TITLE | | SCALE | DATE | DR | DWG | REV |
|-----------------------|--|-------|--------|-----|---------|-----|
| 100 SP-1 T1 B1 M6 Q E | | 2:1 | 4/9/02 | CJB | T111014 | F |



THE INFORMATION CONTAINED IN THIS DOCUMENT IS PROPRIETARY TO E-SWITCH AND IS NOT TO BE COPIED OR TRANSFERRED