



THREE FLANGE DUAL PRIMARY 5.0VA PC BOARD POWER TRANSFORMER

REV. Status

REVISION -
10/22/99 TS

REVISION A
CHANGED F
SEE PG. 2
11/22/99 TS

REVISION B
CHANGED
HI-POT, SAFETY
AND SCHEMATIC.
05/21/01 MP

REVISION C
REV'D HI-POT
09/20/04 MP

REVISION D
ADDED RoHS &
UPDATED LABEL
01/26/06 MP

A. Electrical Specifications (@ 25 °C)

1. Maximum Power; 5.0VA
2. Input Voltage and Frequency; 115/230V 50/60Hz
3. Voltage Regulation; 20% TYP @ full load to no load
4. Temperature Rise; 30°C TYP (45°C MAX allowed)
5. Insulation Resistance;
100MΩ MIN @ 500VDC, Pri to Sec, Pri to Core, Sec to Core
6. Hi-Pot; 3500Vrms 1 minute @ Pri to Sec
1500Vrms 1 minute @ Pri to Core
1500Vrms 1 minute @ Sec to Core

B. Marking; TAMURA, MICROTRAN, part number (see sheet 2), date code, country of origin, terminal numbers and input and output ratings (see sheet 2)

C. Safety:

CSA File Nos. LR69222 and LR69223
UL 1411 File No. E138028 Construction only
UL 506, General Purpose, File No. E79781.
Insulation Class B (130°C) File No. E92957
TUV File 810/89 (EN60950, and VDE 0551)
94V-0 Flammability



D. Mechanical Specifications;



MODEL NUMBER

PL5.0-XX-130B

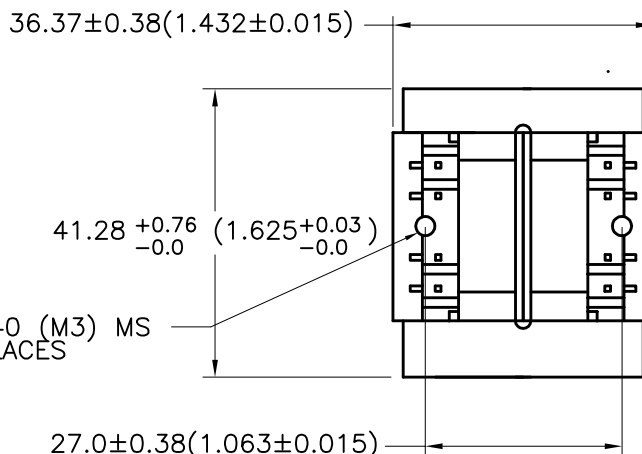
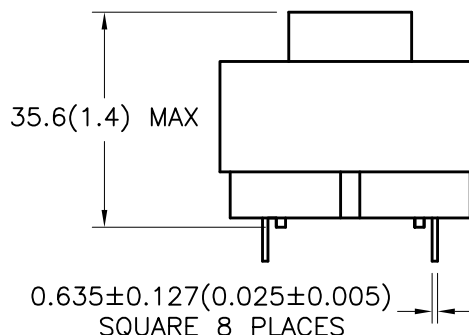
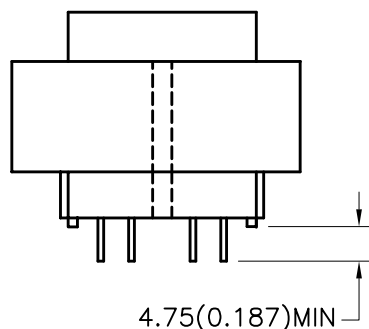
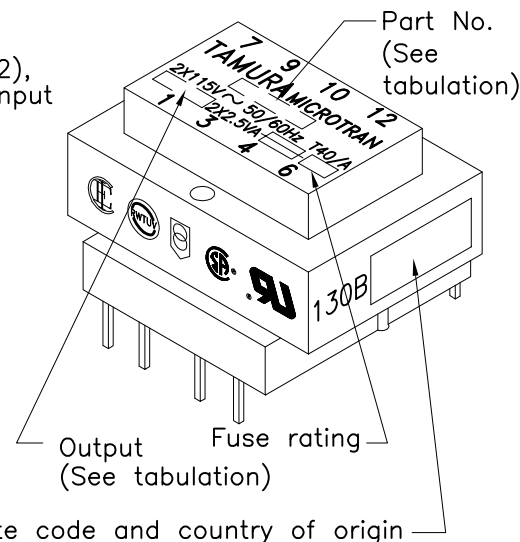

CLEARANCE HOLE FOR 4-40 (M3) MS
Ø2.87(0.113) MIN. 2 PLACES

TOLERANCES (mm)

≤ 4	± 0.2
4 ≤ 20	± 0.3
20 ≤ 50	± 0.4

PREPARED BY:

K. BRENNAN

ENGINEER:

M. PITCHAI

QUALITY CONTROL:

T. CLEM

APPROVED:

Y. SEKIGUCHI

DWG CONTROL NO.
P-A1-12225
ACAD\MXFMR\A1122251.DWG

REV
D

POWER
TRANSFORMER

TAMURA CORPORATION OF AMERICA
43352 BUSINESS PARK DRIVE, TEMECULA, CA. 92590-6624
(951) 699-1270 FAX 9516769482

PL5.0-XX-130B

MODEL SPECIFICATION

DIM: mm(In) SCL: 1/1 SH: 1 OF 2

PROPRIETARY NOTICE: THIS DRAWING PRINT OR DOCUMENT AND SUBJECT MATTER DISCLOSED HEREIN ARE PROPRIETARY ITEMS TO WHICH TAMURA RETAINS THE EXCLUSIVE RIGHT OF DISSEMINATION, REPRODUCTION, MANUFACTURE AND SALE. THIS DRAWING, PRINT OR DOCUMENT IS SUBMITTED IN CONFIDENCE FOR CONSIDERATION BY THE RECIPIENT ALONE UNLESS PERMISSION FOR FURTHER DISCLOSURE IS EXPRESSLY GRANTED IN WRITING.

E. Mounting Footprint;

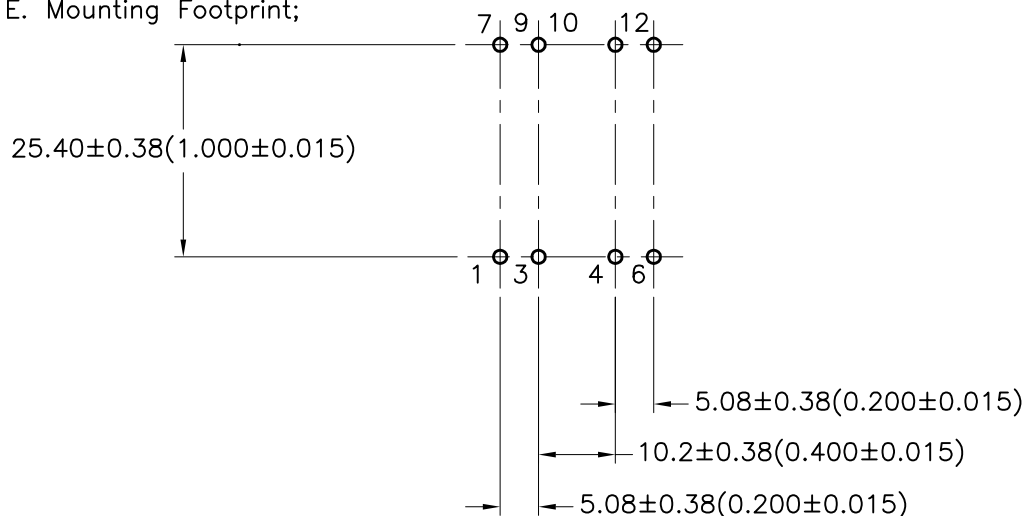

F. Schematic Diagram:

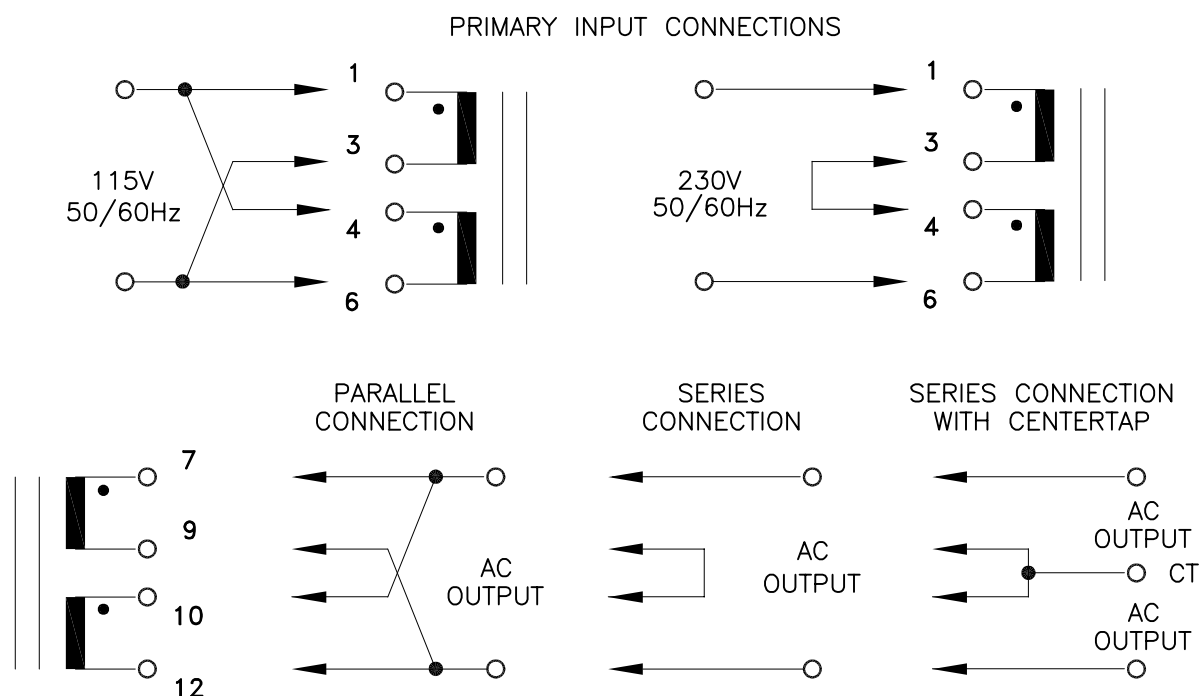

PART NO.	PARALLEL CONNECTION		SERIES CONNECTION		OUTPUT
	AC VOLTS	RMS AMPS	AC VOLTS	RMS AMPS	
PL5.0-10-130B	5.0	1.0	10.0CT	0.5	2X5.0V
PL5.0-12-130B	6.3	0.8	12.6CT	0.4	2X6.3V
PL5.0-16-130B	8.0	0.62	16.0CT	0.31	2X8.0V
PL5.0-20-130B	10.0	0.5	20.0CT	0.25	2X10.0V
PL5.0-24-130B	12.0	0.42	24.0CT	0.21	2X12.0V
PL5.0-28-130B	14.0	0.36	28.0CT	0.18	2X14.0V
PL5.0-36-130B	18.0	0.28	36.0CT	0.14	2X18.0V

PREPARED BY:

K. BRENNAN

ENGINEER:

M. PITCHAI

QUALITY CONTROL:

T. CLEM

APPROVED:

Y. SEKIGUCHI

DWG CONTROL NO.
P-A1-12225
ACAD\MXFMR\A1122252.DWG

REV
D

POWER
TRANSFORMER

CONTENTS OF THIS DRAWING ARE
SUBJECT TO CHANGE WITHOUT
PRIOR NOTICE

TAMURA CORPORATION OF AMERICA
43352 BUSINESS PARK DRIVE, TEMECULA, CA. 92590-6624
(951) 699-1270 FAX 9516769482

PL5.0-XX-130B

MODEL SPECIFICATION

DIM: mm(In) SCL: 1/1 SH: 2 OF 2

PROPRIETARY NOTICE: THIS DRAWING PRINT OR DOCUMENT AND SUBJECT MATTER DISCLOSED HEREIN ARE PROPRIETARY ITEMS TO WHICH TAMURA RETAINS THE EXCLUSIVE RIGHT OF DISSEMINATION, REPRODUCTION, MANUFACTURE AND SALE. THIS DRAWING, PRINT OR DOCUMENT IS SUBMITTED IN CONFIDENCE FOR CONSIDERATION BY THE RECIPIENT ALONE UNLESS PERMISSION FOR FURTHER DISCLOSURE IS EXPRESSLY GRANTED IN WRITING.

MODEL NUMBER

PL5.0-XX-130B